

MARKING DETAILS

BABCOCK SUPPLY		
\blacksquare 3600 L	\square 10000 L	\square 2006
\square 4500 L	\square 11365 L	\blacksquare 2007
\square 5600 L	\square 13640 L	\square 2008
\square 6800 L	\square 15900 L	\square P
\square 9100 L	\square T	\blacksquare H
MAXIMUM BURIAL DEPTH 1.5 m		
NON-SUL A.S.I.A.P. R.McNEIL		

CAST IN CONCRETE INLET END BESIDE ACCESS

Standard Construction – 800 G / 3600 L single compartment tank
 Concrete: 35 MPA at 28 days, 5–8% air entrainment, 0.45 water/cement ratio
 Reinforcing: Rebar Gr400W 10m & 15m – 1" [25mm] min. concrete coverage
 Structural fibre – virgin copolymer polypropylene
 Liquid Depth: 48" [1219mm]
 Working Capacity: 841 G [3823 L]
 Air Capacity: 137 G [622 L]

Notes:

- 'DO NOT ENTER DANGER NE PAS ENTRER' tags on H.D.P.E. access covers
- Inlet and Outlet marked on appropriate ends
- $\frac{1}{2}$ " [13mm] butyl sealant used to seal lid to tank
- Tank is assembled at Babcock Supply Ltd
- Tank is intended for non-sulphate soil only
- Above ground installation not permitted
- Inlet and outlet will accept NPS-4 pipe (E.P.A. pipe seals)
- Lid weight = 1920 lbs [871 kg]
- Tank weight = 6155 lbs [2998 kg]
- Assembled weight = 8075 lbs [3662 kg]
- Maximum burial depth = 60" [1524 mm]
- Excavate hole approximately 12" [305 mm] larger than outside of tank

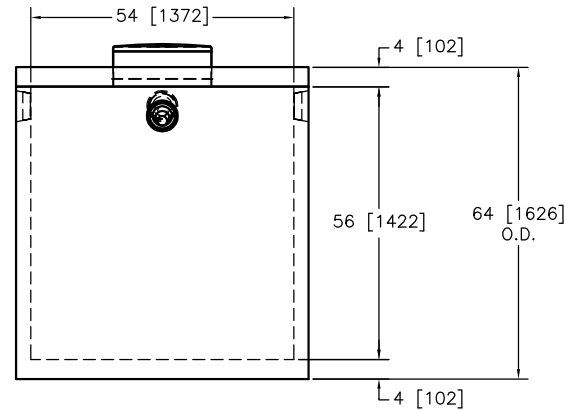
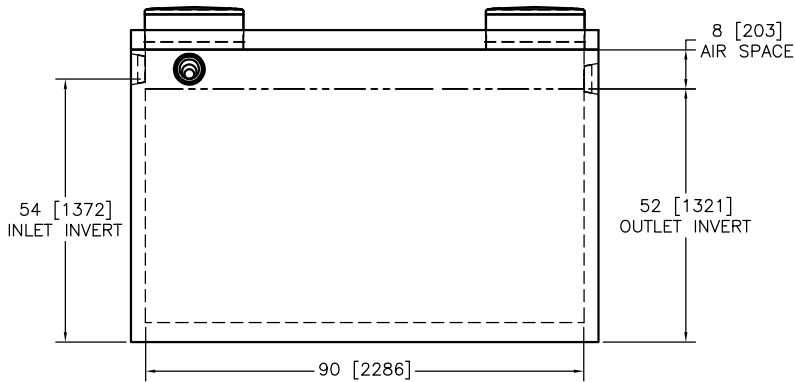

Babcock Supply Ltd.
PRECAST CONCRETE PRODUCTS

DRESDEN, ONT.

PHONE
519-683-2696

FAX
519-683-2548

TANK MODEL #

800 GALLON - 3600 LITRE
SINGLE COMPARTMENT

DWG #

800GSINGLE