

MARKING DETAILS

BABCOCK SUPPLY		
3800 L	10000 L	2008
4500 L	11365 L	2007
5800 L	13640 L	2008
6800 L	15900 L	P
9100 L		H
		T
		H
MAXIMUM BURIAL DEPTH 1.5 m		
NON-SUL	A.G.I.N.P.	R.M.I.N.E.L.

CAST IN CONCRETE INLET END BESIDE ACCESS

Standard Construction - 1500 G / 6800 L trickle type septic tank  
 Concrete: 35 MPA at 28 days, +/- 6% air entrainment  
 Reinforcing: Rebar Gr400W. 10m & 15m - 1" [25mm] min. concrete coverage  
 Structural fibre - virgin copolymer polypropylene  
 Liquid Depth: 49 1/2" [1250mm]  
 Working Capacity: 1525 G [6933 L]  
 Air Capacity: 261 G [1187 L]

Notes:

1. Inlet baffle - P.V.C. pipe style
2. Outlet baffle - P.V.C. pipe style
3. Partition wall is monolithically cast with side walls and floor
4. 'DO NOT ENTER DANGER NE PAS ENTRER' marked on access covers
5. 3/4" [13mm] butyl sealant used to seal lid to tank
6. Tank is assembled at Babcock Supply Ltd.
7. Tank is intended for non-sulphate soil only
8. Above ground installation not permitted
9. Inlets and outlet will accept NPS-4 pipe (Polylok III seals)
10. Lid weight = 4360 lbs [1977 kg]
11. Tank weight = 13450 lbs [6100 kg]
12. Assembled weight = 19100 lbs [8662 kg]
13. Maximum burial depth = 60" [1524 mm]
14. Excavate hole approximately 12" [305 mm] larger than outside of tank

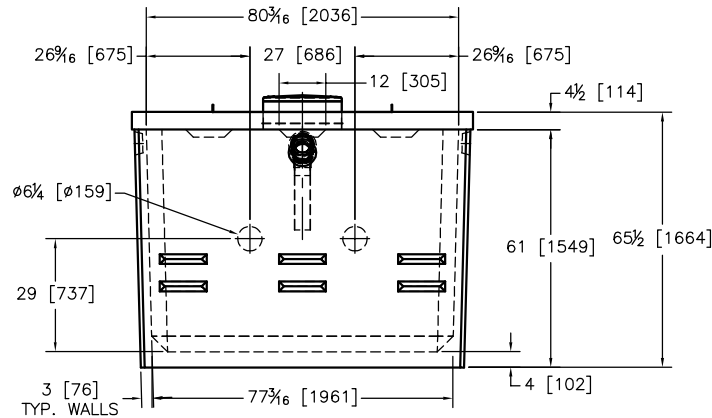

**Babcock Supply Ltd.**  
 PRECAST CONCRETE PRODUCTS

DRESDEN, ONT.

PHONE  
 519-683-2696

FAX  
 519-683-2548

TANK MODEL #

**1500 GALLON / 6800 LITRE  
 SEPTIC TANK MODEL B**

DWG #

**1500GBSEPTIC**