

MARKING DETAILS

BABCOCK SUPPLY		
□ 3600 L	□ 10000 L	■ 2006
■ 4500 L	□ 11365 L	□ 2007
□ 5800 L	□ 13840 L	□ 2008
□ 6800 L	□ 15900 L	□ P
□ 9100 L	□ T	■ H
MAXIMUM BURIAL DEPTH 1.5m		
NON-SUL	A.G.I.N.P.	R.M.NEIL

CAST IN CONCRETE INLET END BESIDE ACCESS

Standard Construction - 1000 G / 4500 L single compartment tank
 Concrete: 35 MPA at 28 days, 5-8% air entrainment, 0.45 water/cement ratio
 Reinforcing: Rebar Gr400W, 10m & 15m - 1" [25mm] min. concrete coverage
 Structural fibre - virgin copolymer polypropylene
 Liquid Depth: 48" [1219mm]
 Working Capacity: 1051 G [4778 L]
 Air Capacity: 205 G [931 L]

Notes:

- 'DO NOT ENTER DANGER NE PAS ENTRER' tags on H.D.P.E. access covers
- Inlet and Outlet marked on appropriate ends
- ½" [13mm] butyl sealant used to seal lid to tank
- Tank is assembled at Babcock Supply Ltd
- Tank is intended for non-sulphate soil only
- Above ground installation not permitted
- Inlets and outlet will accept NPS-4 pipe (E.P.A. pipe seals)
- Lid weight = 2400 lbs [1088 kg]
- Tank weight = 6945 lbs [3150 kg]
- Assembled weight = 9345 lbs [4238 kg]
- Maximum burial depth = 60" [1524 mm]
- Excavate hole approximately 12" [305 mm] larger than outside of tank

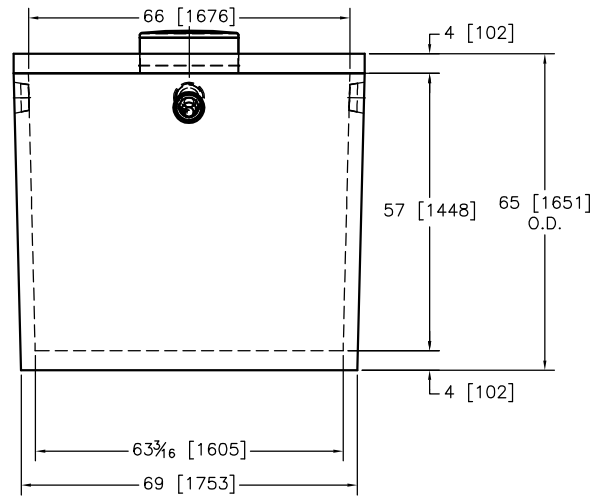
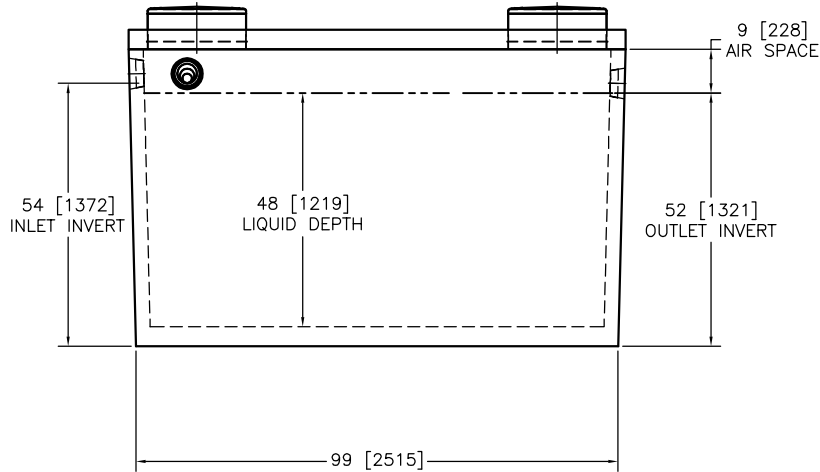

Babcock Supply Ltd.
PRECAST CONCRETE PRODUCTS

DRESDEN, ONT.

PHONE
519-683-2696

FAX
519-683-2548

TANK MODEL #

**1000 GALLON - 4500 LITRE
 SINGLE COMPARTMENT TANK**

DWG #

1000GSINGLE